

Maxxmar™ Window Fashions

Lifetime Limited Warranty



WARRANTY: The manufacturer Maxxmar™ Window Fashions, warrants all blinds and shades under a Lifetime Limited Warranty. This warranty covers and inclusive against any defects in material and workmanship for as long as the original purchaser owns the products as long as the products were installed in accordance with the supplied instructions in a residential building for the opening/window they were purchased for and the products are manually operated which have not been altered, tampered with or modified. This warranty does not cover any damage caused by or resulting from misuse, abuse, alterations or excessive discoloration due to sunlight or passage of time, humidity, exposure to salty air, change in atmospheric conditions or corrosive materials. This warranty also does not apply to conditions caused by normal wear and tear upon the actual product.

Headrail / Manual Components/ Brackets: all moving parts in manually operated product in all blinds and shades are covered by the Lifetime Limited Warranty under normal use as detailed above.

Fabrics/Materials:

- 1) Pleated, Cellular, Alternative Shades, Roller, Roman and Panel Track: under normal use for a period of five (5) under normal use inclusive of excessive discoloration or burn out. This warranty does not cover curling, soiling, scratching, normal fading or loss of color intensity from use.
- 2) Regular Wood, Special Finish Wood and Faux Wood Slats: under normal use for a period of three (3) years against cracking, peeling, excessive fading, and extreme loss of color intensity or warping. This warranty does not cover variations in texture, color grain nor does it cover product installed in areas of high humidity.

General: Colours and intensity under dye lots may vary within commercial tolerances as a result colours of both fabrics and materials may vary from sample books. We are unable to guarantee exact dye lots as illustrated in sample books.

In the event of a defect under this warranty, the product purchaser must notify the retailer immediately upon detection of the defect first appearing. The retailer will return the product to the manufacturer to determine whether the defect is covered and once determined the product will be either repaired or replaced. If it is not covered under the warranty then the manufacturer will advise the retailer of the cost to repair as well as give options to address the defect.

PRODUCT SAFETY: Comprehensive bilingual warning tags, stickers and installation labels are on all manufactured custom product, which communicates the important safety issues to the consumer. Do not place near cribs, children's beds or any furniture near window treatments. Please read installation instructions thoroughly, install all supplied safety hardware as indicated including, but not limited to cord cleats, tension devices and cord weights and ensure there are not any closed cord loops which are accessible or within the reach of children.

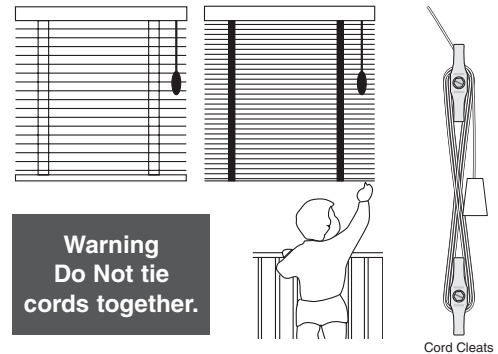

CLEANING: All products can be easily maintained by light dusting with a feather duster, soft cloth, dusting mitt or brush type attachments on vacuums. When cleaning any product with water (exception for wood blinds which should never be cleaned with water), use a lukewarm damp sponge and wipe with light strokes.